

In Europe, the new architecture of the 1920s re-appraised the house plan and based its findings upon functional rather than decorative criteria. In 1923, the Bauhaus exhibited a one-family house called 'Das Haus am Horn'. Here the L-shaped kitchen had a storage centre with the sink and sideboard placed along the wall. The sideboard was split into two elements – a base cabinet and wall cabinets. The worktop continued round the corner, flush up to the gas cooker, which had another worktop on the other side.

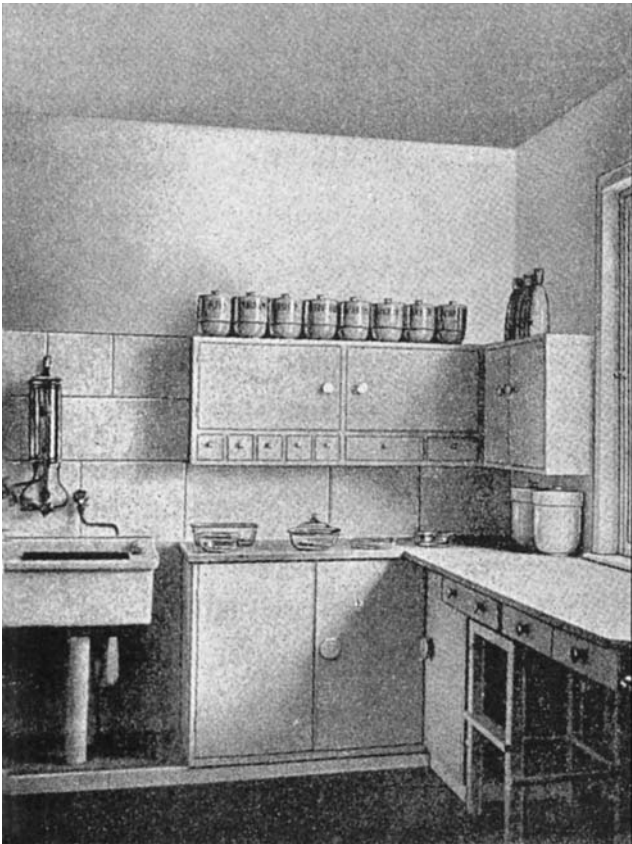

'Das Haus am Horn' in the Bauhaus Exhibition 1923

In 1927, J.J.P Oud designed low-cost kitchens for houses in the Weissenhof Siedlung in Stuttgart. These kitchens had a large window and an L-shaped run of continuous worktops with a preparation area, a sink, a food chest vented to the outside and a refuse can emptied from the yard. The cooker was placed to the left of a hatchway communicating directly with the dining room.

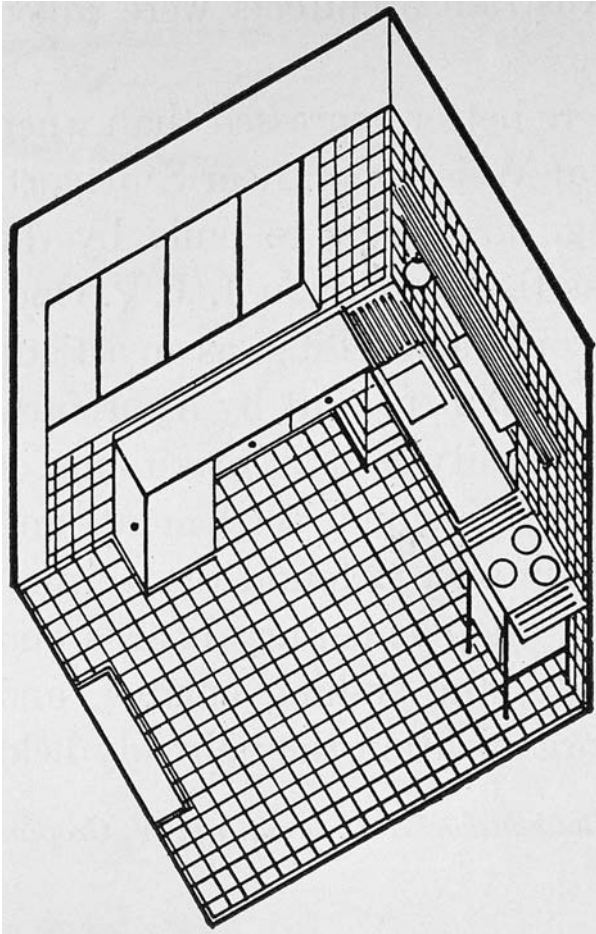

Kitchen by JJP Oud for the Weissenhof Siedlung, Stuttgart 1927